



heatilator®

The first name in fireplaces



Heirloom

Direct Vent Gas Fireplace

Heirloom



authentic masonry style
powerful heat

The Heirloom provides authentic masonry style without the costs of a site-built masonry fireplace. The largest 36, 42 and 50-inch viewing areas in their class showcase intense fires and textured brick refractories. Powerful heat and high-efficiency performance help make the Heirloom a welcomed addition to any home.

Enjoy total control while operating your fireplace. It is simple, smart and safe with IntelliFire™ Touch. Select the touchscreen remote control or wireless wall switch for the solution that fits your life.



Features

- Authentic masonry style without the costs of a site-built masonry fireplace
- 36", 42" and 50" viewing areas
- Variable flame control up to 65,000 BTUs
- High-efficiency, AFUE-rated performance
- Standard IntelliFire™ Touch remote control features touchscreen and offers the most intuitive control system that is simple, smart and safe
- Choose from standard traditional or herringbone interior panels, or optional fade-resistant reflective black glass interior panels
- Finish it your way with a choice of decorative firescreen fronts with fine mesh for a clear view of the fire
- Heater listed to ANSI Z21.88 standards

Options

Fronts and Doors

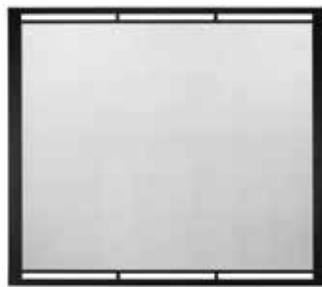

Firescreen

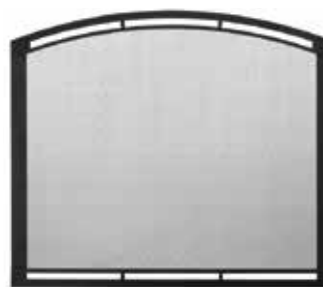

Firescreen Arch

Finishes

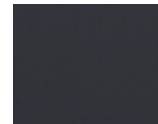

Black



Bronze

Interiors



Traditional



Herringbone



Fade-resistant reflective black glass

Additional Options Not Pictured

- Heat Zone kit
- Heat Out kit
- Gas conversion kits
- Mantels and surrounds

Venting

- Direct Vent: DVP pipe

Controls



IntelliFire™ Touch RC400 Touchscreen Remote Control

Included standard with Heirloom, a large LCD screen and simple navigation provide easy operation. Feel confident knowing alerts and notifications will appear when needed. The RC400 acts as a thermostat and can be used as a remote, or docked on the wall.

Features: on/off, flame height adjustment, fan speed, lights adjustment, thermostat mode, room temperature readout, child lock, timer mode, automatic battery backup, cold climate mode, power vent, wall docking station (fan, lights and power vent are dependent on your fireplace)



IntelliFire™ Touch RC150 Wireless Wall Switch

An optional addition to Heirloom, push the switch for fire and ambiance, while audible feedback confirms commands and ensures safe functioning. This simple switch is designed for wall placement.

Features: on/off, battery strength indicator, automatic battery backup, cold climate mode

Cover: Heirloom shown with firescreen in bronze with fade-resistant reflective black glass interior panels

Left: Heirloom shown with firescreen arch in bronze with herringbone interior panels



Technical Specifications

| MODEL | FRONT WIDTH (A) | BACK WIDTH (H) | HEIGHT (E) | DEPTH | GLASS SIZE |
|--------|-----------------|-------------------|------------------|-------------|---------------------------|
| HEIR36 | 61" (1549mm) | 59-1/4" (1505mm) | 57-5/8" (1464mm) | 24" (610mm) | 36" x 31" (914 x 787mm) |
| HEIR42 | 67" (1702mm) | 65-5/16" (1659mm) | 62-5/8" (1591mm) | 24" (610mm) | 42" x 36" (1067 x 914mm) |
| HEIR50 | 75" (1905mm) | 73-5/16" (1862mm) | 66-5/8" (1692mm) | 24" (610mm) | 50" x 40" (1270 x 1016mm) |

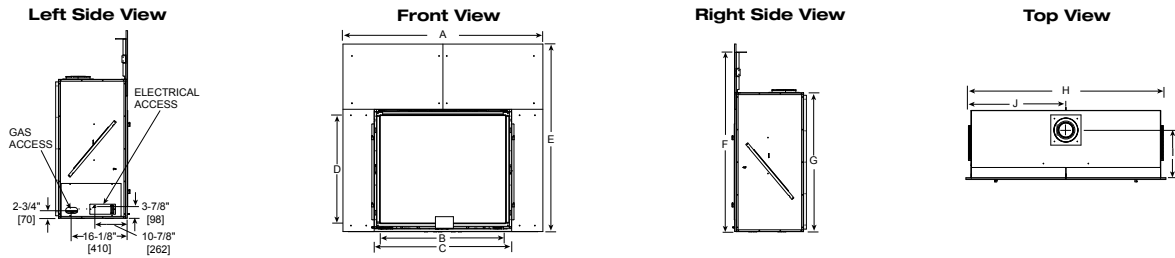

*Front dimensions include non-combustible material which overlaps framing

| MODEL | A | B | C | D | E | F | G | H | I | J |
|--------|--------------|------------------|------------------|-------------------|------------------|--------------------|------------------|-------------------|-------------|-------------------|
| HEIR36 | 61" (1549mm) | 35-7/8" (911mm) | 39-7/8" (1013mm) | 31-1/16" (789mm) | 57-5/8" (1464mm) | 54-15/16" (1395mm) | 41-3/8" (1042mm) | 59-1/4" (1505mm) | 16" (406mm) | 29-5/8" (752mm) |
| HEIR42 | 67" (1702mm) | 41-7/8" (1064mm) | 45-7/8" (1165mm) | 36-1/16" (916mm) | 62-5/8" (1591mm) | 59-15/16" (1522mm) | 46-3/8" (1178mm) | 65-5/16" (1659mm) | 16" (406mm) | 32-11/16" (830mm) |
| HEIR50 | 75" (1905mm) | 49-7/8" (1267mm) | 53-7/8" (1368mm) | 40-1/16" (1018mm) | 66-5/8" (1692mm) | 63-15/16" (1624mm) | 50-3/8" (1280mm) | 73-5/16" (1862mm) | 16" (406mm) | 36-11/16" (932mm) |

Clearances

| MODEL | A | B | C |
|--------|-------------------|-------------------|-------------------|
| HEIR36 | 74-1/4" (1886mm) | 59-1/2" (1511mm) | 105" (2667mm) |
| HEIR42 | 78-9/16" (1995mm) | 65-9/16" (1665mm) | 111-1/16" (2821) |
| HEIR50 | 84-1/4" (2140mm) | 73-9/16" (1868mm) | 119-1/8" (3026mm) |

| MODEL | D | E | F |
|--------|-----------------|-----------------|-------------------|
| HEIR36 | 26-1/2" (673mm) | 23-1/2" (597mm) | 29-3/4" (756mm) |
| HEIR42 | 28-5/8" (727mm) | 23-1/2" (597mm) | 32-13/16" (833mm) |
| HEIR50 | 31-1/2" (800mm) | 23-1/2" (597mm) | 36-13/16" (935mm) |

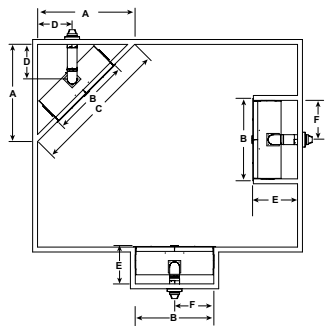

Framing

| MODEL | A ROUGH OPENING WIDTH | B ROUGH OPENING HEIGHT | C ROUGH OPENING DEPTH | D ROUGH OPENING WIDTH | E CLEARANCE TO CEILING |
|--------|-----------------------------|------------------------------|-----------------------------|-----------------------------|------------------------------|
| HEIR36 | 10" (254mm) | 56" (1422mm) | 24" (610mm) | 59-1/2" (1511mm) | 52" (1321mm) |
| HEIR42 | 10" (254mm) | 61" (1549mm) | 24" (610mm) | 65-9/16" (1665mm) | 52" (1321mm) |
| HEIR50 | 10" (254mm) | 65" (1651mm) | 24" (610mm) | 73-9/16" (1868mm) | 52" (1321mm) |

| MODEL | F COMBUSTIBLE TO FLOOR | G COMBUSTIBLE FLOORING | H BEHIND APPLIANCE | I SIDES OF APPLIANCE | J FRONT OF APPLIANCE |
|--------|------------------------------|------------------------------|--------------------------|----------------------------|----------------------------|
| HEIR36 | 0" (0mm) | See Install Manual | 1" (25mm) | 1" (25mm) | 36" (914mm) |
| HEIR42 | 0" (0mm) | See Install Manual | 1" (25mm) | 1" (25mm) | 36" (914mm) |
| HEIR50 | 0" (0mm) | See Install Manual | 1" (25mm) | 1" (25mm) | 36" (914mm) |

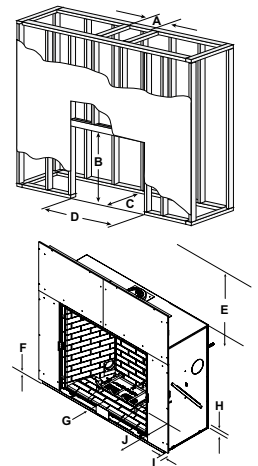

Technologies

IntelliFire Touch Ignition System

IntelliFire Touch is the most advanced and intuitive IntelliFire system, making operating your fireplace simple, smart and safe. Select the wireless wall switch or touchscreen remote control for the solution that fits your life.

Direct Vent Technology

Direct vent technology removes 100% of combustion exhaust and fumes from your home. These sealed fireplaces provide optimal heat, conserve energy and ensure clean, safe indoor air quality.

EnerGuide (CSA P.4.1-15) Ratings

Used in Canada and some U.S. states to measure annual fireplace efficiency.

| RATING | HEIR36T/H | HEIR42T/H | HEIR50T/H |
|--------------------------|-----------|-----------|-----------|
| EnerGuide (CSA P.4.1-15) | 59.6% | 67.0% | 67.5% |

Exceptional Value + Dependability

Why do contractors, architects and homebuyers trust Heatilator? Because we mix value with dependability. Established in 1927, Heatilator has built a long standing reputation for providing quality, dependable hearth products at unbeatable values. Today, Heatilator remains the most preferred, recommended and installed fireplace brand among building professionals.

Available from

heatilator
The first name in fireplaces

800-927-6841 | heatilator.com
[facebook.com/Heatilator](https://www.facebook.com/Heatilator)
twitter.com/Heatilator
[youtube.com/HeatilatorFireplaces](https://www.youtube.com/HeatilatorFireplaces)

Limited Lifetime Warranty¹

The strongest in the industry, Heatilator provides a limited lifetime warranty on gas-burning products of the most important aspects: firebox and heat exchanger.

¹ For full warranty details go to heatilator.com.

The information provided in this literature is for planning purposes only and subject to change. Please consult the installation manual for actual installation. Actual product appearance may differ from product images.

Fireplace glass and other surfaces get extremely HOT and can cause severe burns if touched. Keep a safe distance away. To learn more visit www.heatilator.com/fireplacesafety.

HTL-1081U-0517

